

ONKYO

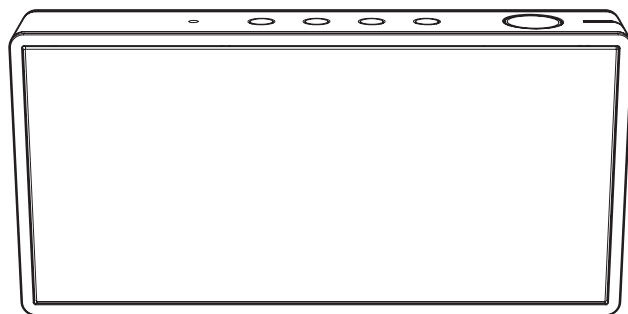

T3

User
manual

Contents

1	Important	2
----------	------------------	---

2	Your Bluetooth speaker	3
	Introduction	3
	What's in the box	3
	Overview of the speaker	4

3	Get started	5
	Turn on/off	5
	Check the battery level	5
	Charge the built-in battery	5

4	Use Bluetooth devices	7
	Connect a Bluetooth-enabled device	7
	Connect two Bluetooth devices simultaneously	7
	Play from Bluetooth device	8
	Control your phone call	8

5	Other features	9
	Charge your mobile devices	9
	Enable/disable voice prompt	9
	Use the detachable case	9
	Reset the speaker	9

6	Product information	10
	Specifications	10

7	Troubleshooting	11
	General	11

8	Notice	12
----------	---------------	----

1 Important



Warning

- Never remove the casing of this speaker.
 - Never lubricate any part of this speaker.
 - Never place this speaker on other electrical equipment.
 - Keep this speaker away from direct sunlight, naked flames or heat.
-
- Make sure that there is enough free space around the speaker for ventilation.
 - Only use attachments or accessories specified by the manufacturer.
 - The battery shall not be exposed to excessive heat such as sunshine, fire or the like.
 - The speaker shall not be exposed to dripping or splashing.
 - Do not place any sources of danger on the speaker (e.g. liquid filled objects, lighted candles).



Note

- The type plate is located on the bottom of the product.

About operating temperatures and humidity

- Operate in a place where temperature is between 0°C (32°F) and 40°C (104°F) (up to 80% relative humidity)
- Battery life may be shorter in high or low temperature conditions

2 Your Bluetooth speaker

Thank you for purchasing an Onkyo product. Read this manual carefully before use. By following these instructions, you can get the best audio performance and the most listening pleasure from your Onkyo product.

Introduction

With this speaker, you can

- enjoy audio from your Bluetooth-enabled devices through Bluetooth;
- control the incoming phone call after Bluetooth connection; and
- charge your mobile devices through the USB socket.

What's in the box

Check and identify the contents of your package:

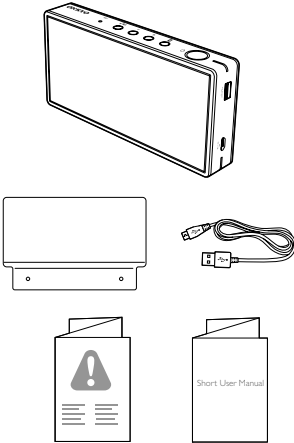

- Main unit
- USB cable
- Detachable case
- Printed materials

Overview of the speaker

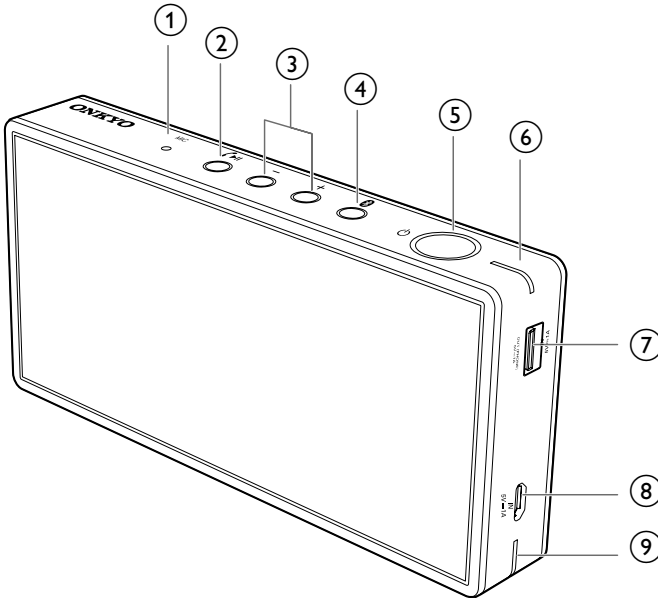

① MIC

- Integrated microphone.

②

- Press to pause or resume play.
- Press twice to go to the previous track or the beginning of the current track.
- Press to answer an incoming call.
- During a call, press to end the current call.

③

- Adjust volume.

④

- Press and hold for two seconds to enter pairing mode.
- Press twice to select the next track.

⑤

- Press and hold for two seconds to turn the speaker on or off.
- Press to check the battery level when the speaker is turned on.

⑥ Bluetooth/power indicator

- Indicate the Bluetooth connection status.
- Indicate the power status.

⑦ OUT [PHONE] (5V \equiv 1A)

- Charge an external mobile device.

⑧ IN (5V \equiv 1A)

- Charge the built-in battery.

⑨ Battery indicator

- Indicate the battery status.

3 Get started

Always follow the instructions in this chapter in sequence.

Turn on/off

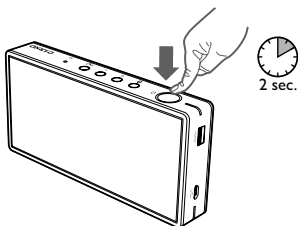

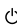
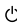
- To turn the speaker on, press and hold  until you hear a tone.
↳ The power/Bluetooth indicator flashes blue.
- To turn the speaker off, press and hold  again.
↳ The power/Bluetooth indicator turns off.

Note

- If there is no operation and audio output for 15 minutes, the speaker automatically turns off for power-saving.

Check the battery level

The speaker is powered by a built-in rechargeable battery. The different color of the battery indicator indicates different battery levels.

Note

- Make sure that the speaker is turned on.

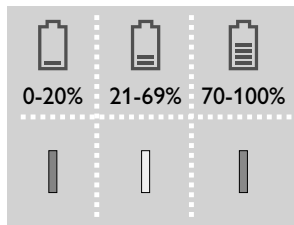
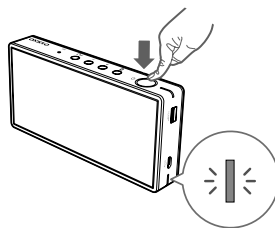

- Press .
↳ The battery indicator turns on for 5 seconds.

Color of Battery Indicator	Battery level
Green	70 - 100% charged
Yellow	21 - 69% charged
Red	0 - 20% charged

Charge the built-in battery

If the battery level is low, recharge the built-in battery.

Note

- The micro USB socket is for charging only.
- Rechargeable battery has a limited number of charge cycles. Battery life and number of charge cycles vary by use and settings.
- It takes approximately three hours to fully charge the battery.

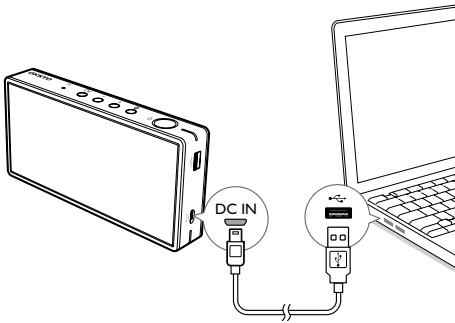

- Connect the supplied USB cable between
 - the **IN (5V \equiv 1A)** socket on the speaker, and
 - a USB socket of a computer.
- ↳ The battery indicator turns solid white.
- ↳ When the battery is fully charged, the battery indicator turns off.

 **Tip**

- If you charge the battery and play music at the same time, the volume will become relatively lower.

4 Use Bluetooth devices

With this speaker, you can listen to audio from Bluetooth-enabled devices and control the incoming call through Bluetooth.

Connect a Bluetooth-enabled device

Note

- Make sure that your Bluetooth device is compatible with this speaker.
- Before pairing a device with this speaker, read its user manual for Bluetooth compatibility.
- Make sure that Bluetooth function is enabled on your device, and your device is set as visible to all other Bluetooth devices.
- Any obstacle between this speaker and a Bluetooth device can reduce the operational range.
- Keep away from any other electronic device that may cause interference.
- The operational range between this speaker and a Bluetooth device is approximately 10 meters (30 feet).

- 1 Make sure that the speaker is in pairing mode.
 - ↳ The power/Bluetooth indicator flashes blue quickly.
 - ↳ If the power/Bluetooth indicator flashes blue slowly, press and hold **0** for two seconds to enter pairing mode.

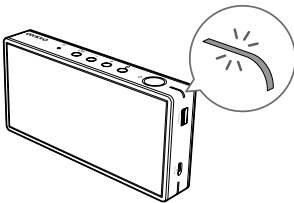

- 2 On your Bluetooth device, enable Bluetooth and search for Bluetooth devices (refer to the user manual of the device).
- 3 When **[Onkyo T3]** is displayed on your device, select it to start pairing and connection. If necessary, enter the default password "0000".
 - ↳ After successful pairing and connection, the speaker beeps, and the power/Bluetooth indicator turns solid blue.

To disconnect the Bluetooth-enabled device:

- Press and hold **0** on the speaker for two seconds;
- Disable Bluetooth on your device; or
- Move the device beyond the communication range.
 - ↳ The power/Bluetooth indicator flashes blue.

To reconnect the Bluetooth-enabled device:

- Next time you turn on the speaker, the speaker tries to reconnect the last connected device automatically;
- If not, manually select "**Onkyo T3**" on your Bluetooth device to start connection.

Connect two Bluetooth devices simultaneously

The speaker can connect to two Bluetooth devices at the same time.

- 1 Connect one Bluetooth device (see the above section "Connect a Bluetooth-enabled device").
- 2 Press and hold **0** for two seconds to enter pairing mode.
 - ↳ The LED indicator flashes blue quickly, and the first device is disconnected.
- 3 Connect the second Bluetooth device.

- 4 Select **[Onkyo T3]** displayed on your first Bluetooth device to start reconnection.
- ↳ The two Bluetooth devices are connected to the speaker at the same time.
 - ↳ If you press and hold **Ⓚ** again for two seconds, the two devices are disconnected, and the speaker is ready to pair with a new device.



Tip

- For a paired Bluetooth device, this speaker tries to reconnect with it once it is detected. If it fails, you just need to select [Onkyo T3] on your device to start reconnection.

Control your phone call

After Bluetooth connection, you can control an incoming call with this speaker.

Button	Function
	Press to answer an incoming call. During a call, press to end the current phone call.



Note

- You can talk through the microphone of the speaker.
- Music play pauses when there is an incoming call, and resumes when your phone call ends.

Play from Bluetooth device



Note

- If there is an incoming call on the connected mobile phone, music play pauses.

After successful Bluetooth connection, play audio on any connected Bluetooth device.

- ↳ Audio streams from your Bluetooth device to the speaker.
- To go to the previous track or the beginning of the current track (depending on the setting of your mobile devices), press **⏮** twice.
- To go to the next track, press **⏭** twice.
- To pause or resume play, press **⏸**.
- To increase or decrease volume, press **+/-**.

5 Other features

Charge your mobile devices

You can charge your mobile devices through the **OUT [PHONE]** socket.

Note

- The USB socket is for charging only.
- Do not connect the IN socket and the OUT [PHONE] socket with the same cable.
- Stop music play while charging your mobile devices.

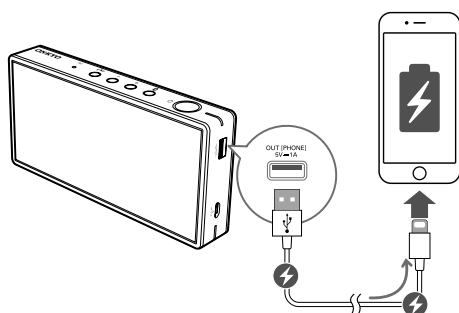

- 1 Turn on the speaker.
- 2 Connect to your mobile device with the USB cable.
 - ↳ Once the device is recognized, the charging starts.
 - ↳ During charging, the speaker turns off automatically.

Enable/disable voice prompt

Press and hold **⏮** for two seconds to enable or disable the voice prompt.

- ↳ When the voice prompt is enabled, the speaker will speak in English.
- ↳ When the voice prompt is disabled, the speaker will change to the tone mode.

Use the detachable case

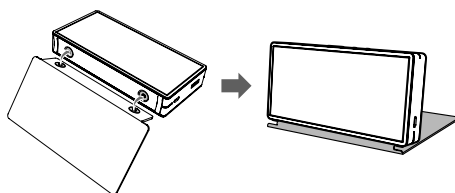

A detachable case is provided to place the speaker on a flat surface. Follow the illustration to install the case.

Reset the speaker

If the system works abnormally, reset the speaker to factory default settings.

- 1 Turn on the speaker.
- 2 Press **⏮** and **0** together for five seconds.
 - ↳ All settings are reset to factory default.

6 Product information

Dimensions	
- Main Unit (W x H x D)	144 x 71 x 23 mm
Weight	
- Main Unit	0.25 kg



Note

- Product information is subject to change without prior notice.

Specifications

Amplifier

Total Output Power	2 x 4 W
Frequency Response	100 Hz - 20 kHz
Total Harmonic Distortion	< 1%

Bluetooth

Bluetooth Version	V4.0
Bluetooth Frequency Band	2.402 - 2.480 GHz
Bluetooth distance	10 m (Free space)

Speakers

Speaker Impedance	8 ohm
Speaker Driver	2 x 1.5" full range
Sensitivity	≥ 79.0 dB/1W/1m

General information

Operation Power Consumption	8 W
Eco Standby Power Consumption	0.1 W
Built-in Battery	Polymer lithium ion battery (800mAh/3.7V X 3)

7 Troubleshooting



Warning

- Never remove the casing of this device.

To keep the warranty valid, never try to repair the system yourself.

If you encounter problems when using this device, check the following points before requesting service. If the problem remains unsolved, contact Onkyo service center.

When you contact Onkyo, make sure that the device is nearby and the model number and serial number are available.

General

No power

- Recharge the built-in battery.

No sound

- Adjust volume on the speaker or the Bluetooth-connected device.
- Make sure that your Bluetooth device is within the effective operational range.

No response from the speaker

- Restart the speaker.

Cannot charge mobile devices

- Make sure that the built-in battery still has power.
- Connect to the mobile phone correctly.

About Bluetooth device

The audio quality is poor after connection with a Bluetooth-enabled device.

- The Bluetooth reception is poor. Move the device closer to this speaker or remove any obstacle between them.

Cannot connect with the device.

- The Bluetooth function of the device is not enabled. Refer to the user manual of the device for how to enable the function.
- The speaker is not in pairing mode. Press and hold **Ⓚ** for two seconds until the power/Bluetooth indicator flashes blue quickly, and then try again.

The paired device connects and disconnects constantly.

- The Bluetooth reception is poor. Move the device closer to this product or remove any obstacle between them.
- For some devices, Bluetooth connection may be deactivated automatically as a power-saving feature. This does not indicate any malfunction of this speaker.

8 Notice

Any changes or modifications made to this device that are not expressly approved by Gibson Innovations may void the user's authority to operate the equipment.

CE 0890

Hereby, Gibson Innovations declares that this product is in compliance with the essential requirements and other relevant provisions of Directive 1999/5/EC. You can find the Declaration of Conformity on www.onkyo-speakers.com.

Disposal of your old product and battery



Your product is designed and manufactured with high quality materials and components, which can be recycled and reused.



This symbol on a product means that the product is covered by European Directive 2012/19/EU.



This symbol means that the product contains a built-in rechargeable battery covered by European Directive 2013/56/EU which cannot be disposed of with normal household waste. We strongly advise you to take your product to an official collection point or an Onkyo service centre to have a professional remove the rechargeable battery.

Inform yourself about the local separate collection system for electrical and

electronic products and rechargeable batteries. Follow local rules and never dispose of the product and rechargeable batteries with normal household waste. Correct disposal of old products and rechargeable batteries helps prevent negative consequences for the environment and human health.

Caution

- Removal of the built-in battery invalidates the warranty and may destroy the product.

Always bring your product to a professional to remove the built-in battery.

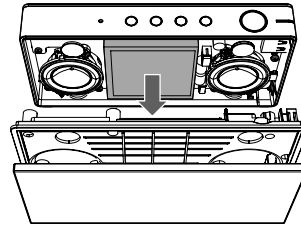

Environmental information

All unnecessary packaging has been omitted. We have tried to make the packaging easy to separate into three materials: cardboard (box), polystyrene foam (buffer) and polyethylene (bags, protective foam sheet.)

Your system consists of materials which can be recycled and reused if disassembled by a specialized company. Please observe the local regulations regarding the disposal of packaging materials, exhausted batteries and old equipment.



The Bluetooth® word mark and logos are registered trademarks owned by Bluetooth SIG, Inc. and any use of such marks by Gibson Innovations Limited is under license. Onkyo® is a registered trade mark of Onkyo Corporation. Other trademarks and trade names are those of their respective owners

ONKYO

www.onkyo-speakers.com

Specifications are subject to change without notice.

2016 © Gibson Innovations Limited. All rights reserved.

This product has been manufactured by, and is sold under the responsibility of Gibson Innovations Ltd., and Gibson Innovations Ltd. is the warrantor in relation to this product.

Onkyo® is a registered trade mark of Onkyo Corporation. Other trademarks and trade names are those of their respective owners.

OKAT3_00_UM_V3.0

CE 0890

EAC

 028

